

# BADOURA TOWNSHIP

## HUBBARD COUNTY

# LEGEND

- FEDERAL #
- STATE #
- COUNTY STATE AID HWY #
- PAVED # GRAVEL
- COUNTY ROAD #
- PAVED # GRAVEL
- TOWNSHIP ROAD #
- MINIMUM MAINTENANCE PAVED GRAVEL
- LOCAL ROAD
- BIKE TRAIL

TOWNSHIP MILEAGE → 13.35

- STATE FOREST
- GAME REFUGE
- NATIVE AMERICAN RESERVATION

- INCORPORATED CITY
- Unincorporated

- ▲ PUBLIC ACCESS
- TOWN OR TOWNSHIP HALL
- ▬ BRIDGE OR BOX CULVERT
- APPROXIMATE SCALE
- 1 MILE
- HUBBARD COUNTY HIGHWAY DEPARTMENT
- REVISED - NOVEMBER 30, 2022

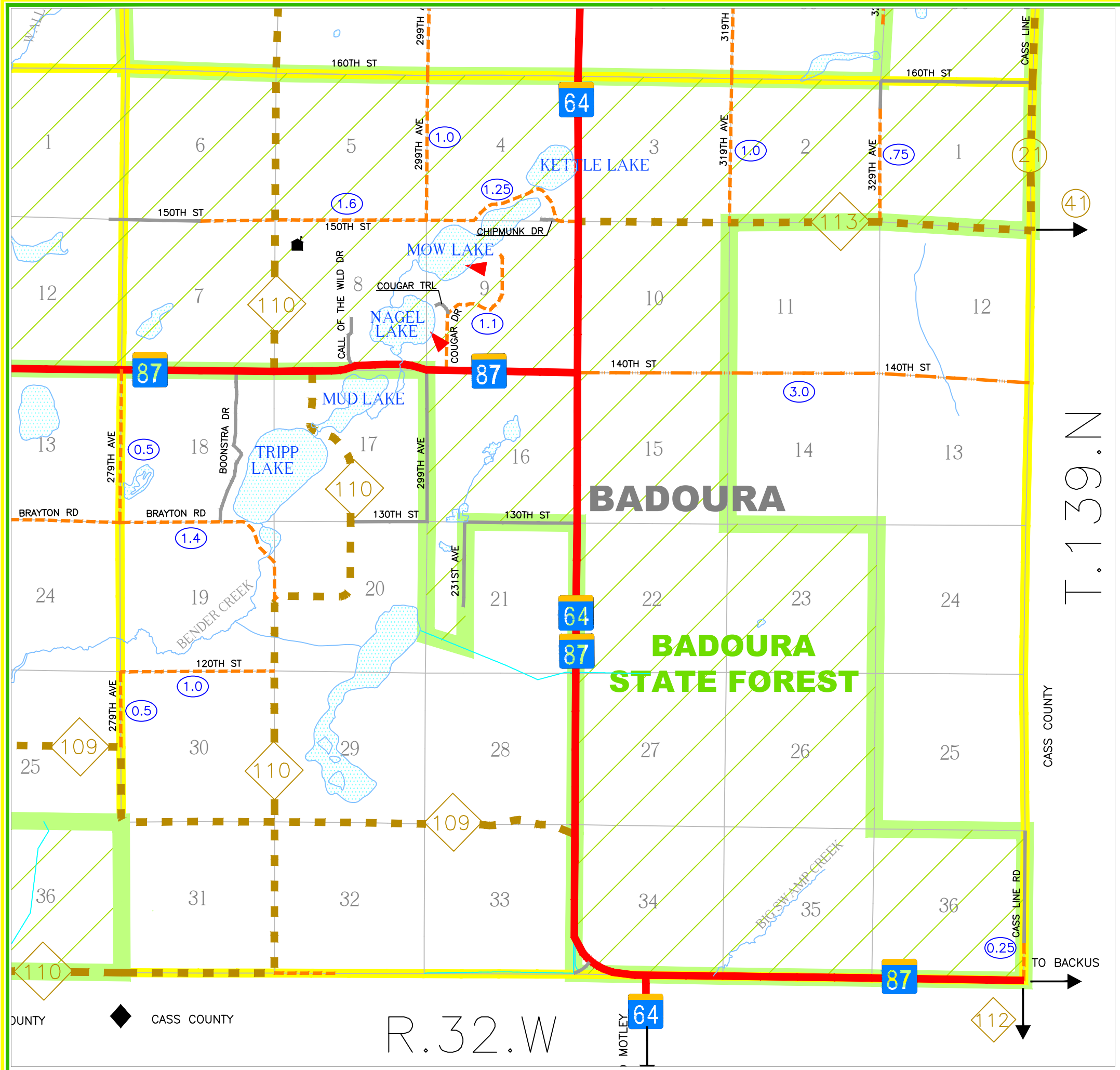

T. 139.N

CASS COUNTY

TO BACKUS

R. 32.W

◆ CASS COUNTY

DUNTY