

BADOURA TOWNSHIP

HUBBARD COUNTY

LEGEND

- FEDERAL #
- STATE #
- COUNTY STATE AID HWY
 - PAVED #
 - GRAVEL #
- COUNTY ROAD
 - PAVED #
 - GRAVEL #
- TOWNSHIP ROAD
 - MINIMUM MAINTENANCE
 - PAVED
 - GRAVEL
- LOCAL ROAD
- BIKE TRAIL

TOWNSHIP MILEAGE → 13.35

- STATE FOREST
- GAME REFUGE
- NATIVE AMERICAN RESERVATION

- INCORPORATED CITY
- Unincorporated

- ▲ PUBLIC ACCESS
- TOWN OR TOWNSHIP HALL
- ▬ BRIDGE OR BOX CULVERT
- APPROXIMATE SCALE
- 1 MILE
- HUBBARD COUNTY HIGHWAY DEPARTMENT
- REVISED - DECEMBER 1, 2021

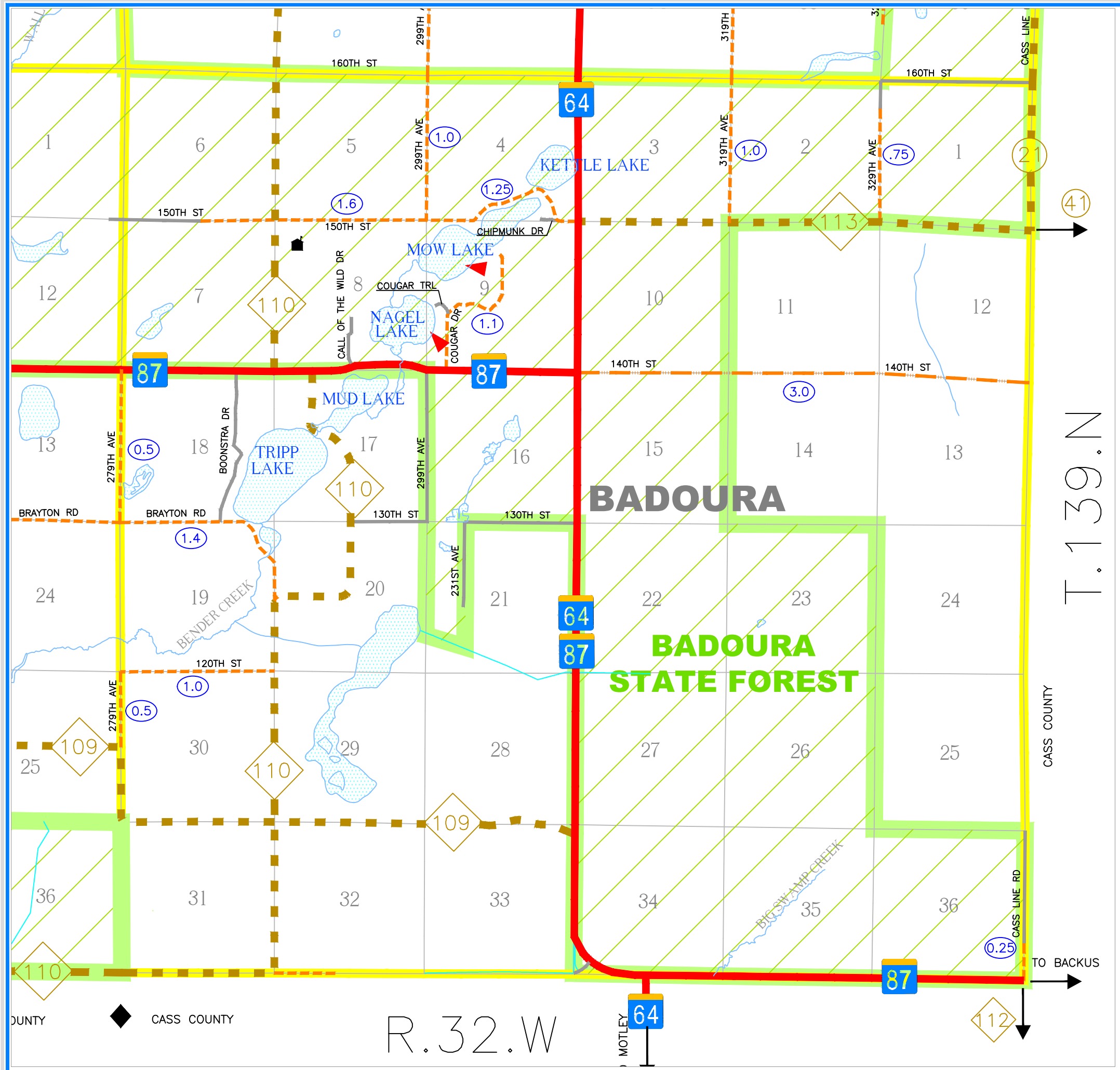

T.139.N

CASS COUNTY

TO BACKUS

R.32.W

◆ CASS COUNTY